

SHEET 60

12/31/12	Tax Map Revisions	SB	REV. BY	CHK.
	REVISED			

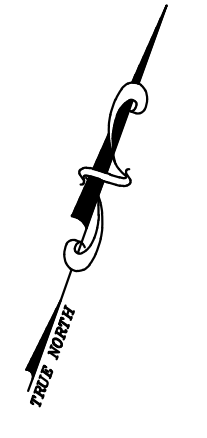

TOWNSHIP OF EDISON - MIDDLESEX COUNTY

NEW JERSEY STATE HIGHWAY ROUTE 4 PARKWAY

SHEET 51

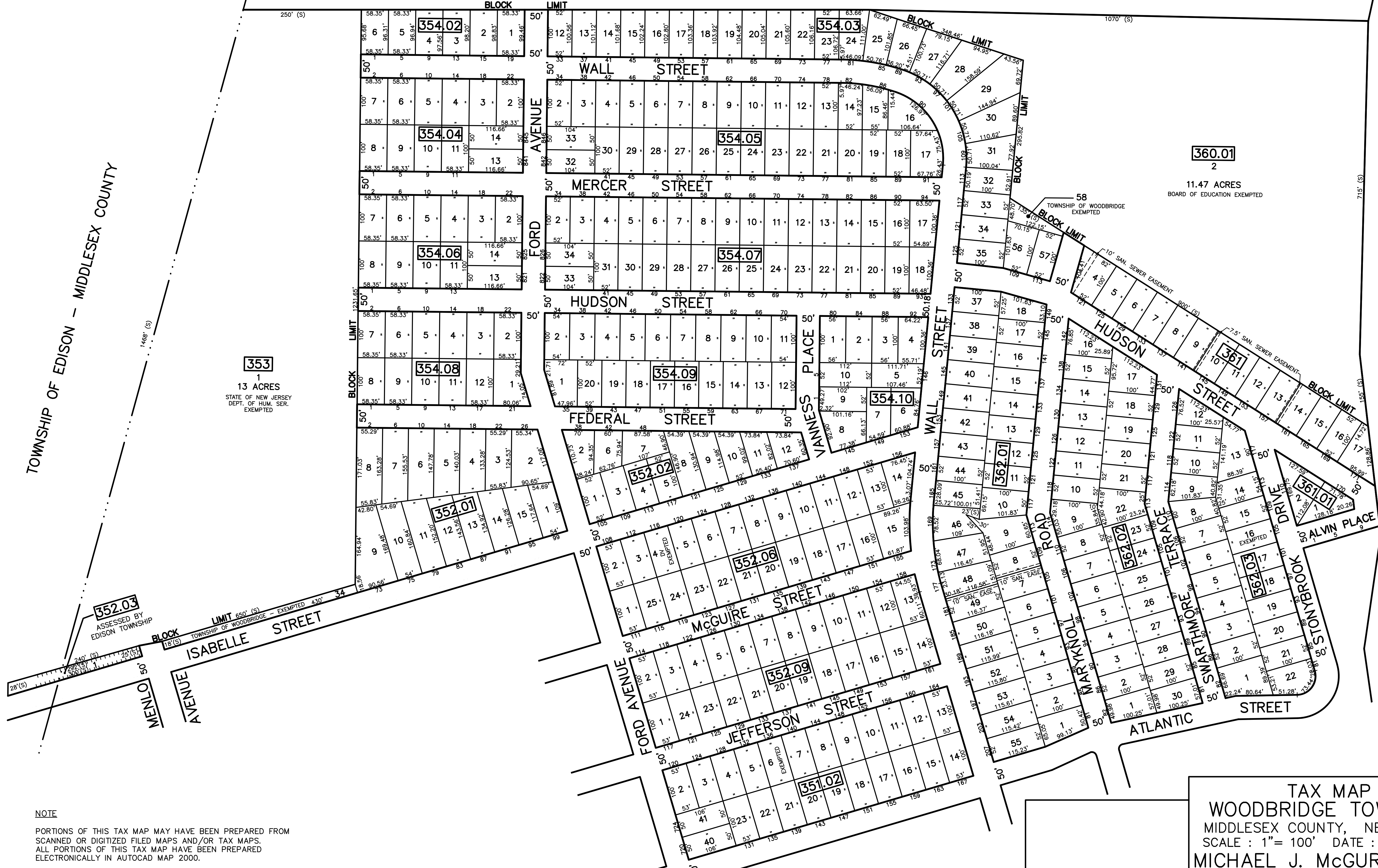

**353**  
1  
13 ACRES  
STATE OF NEW JERSEY  
DEPT. OF HUM. SER.  
EXEMPTED

**352.03**  
ASSESSED BY  
EDISON TOWNSHIP

NOTE  
PORTIONS OF THIS TAX MAP MAY HAVE BEEN PREPARED FROM  
SCANNED OR DIGITIZED FILED MAPS AND/OR TAX MAPS.  
ALL PORTIONS OF THIS TAX MAP HAVE BEEN PREPARED  
ELECTRONICALLY IN AUTOCAD MAP 2000.

TAX MAP  
WOODBIDGE TOWNSHIP  
MIDDLESEX COUNTY, NEW JERSEY  
SCALE : 1" = 100' DATE : JUNE 2008  
MICHAEL J. MCGURL, P.L.S.  
CME ASSOCIATES  
3141 BORDENTOWN AVENUE, PARLIN  
NEW JERSEY, 08859

SHEET 48

SHEET 49