

SHEET 17

12/31/12	Tax Map Revisions	SB
07/11/11	Subdivision-Block 4.19 Lot 7.01	SB
09/02/10	Subdivision-Block 4.19, lot 7	JSE
REVISED	DESCRIPTION	REV. BY
		CHK.

SHEET 9

NEW JERSEY STATE HIGHWAY ROUTE 4 PARKWAY
 NEW JERSEY STATE HIGHWAY ROUTE 9

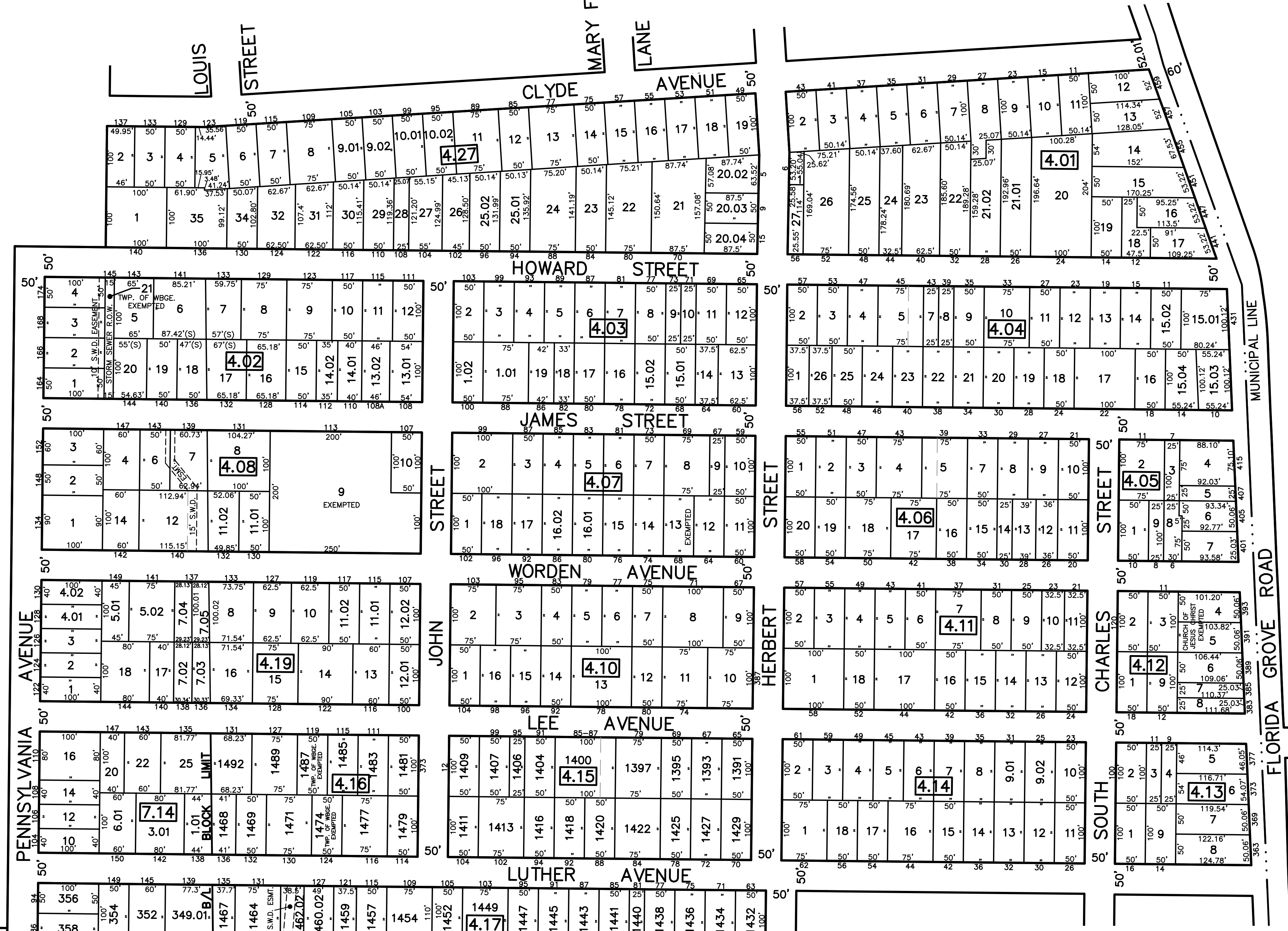

NOTE
 PORTIONS OF THIS TAX MAP MAY HAVE BEEN PREPARED FROM
 SCANNED OR DIGITIZED FILED MAPS AND/OR TAX MAPS.
 ALL PORTIONS OF THIS TAX MAP HAVE BEEN PREPARED
 ELECTRONICALLY IN AUTOCAD MAP 2000.

TAX MAP
 WOODBRIDGE TOWNSHIP
 MIDDLESEX COUNTY, NEW JERSEY
 SCALE : 1"= 100' DATE : JUNE 2008
 MICHAEL J. McGURL, P.L.S.
 CME ASSOCIATES
 3141 BORDENTOWN AVENUE, PARLIN
 NEW JERSEY, 08859

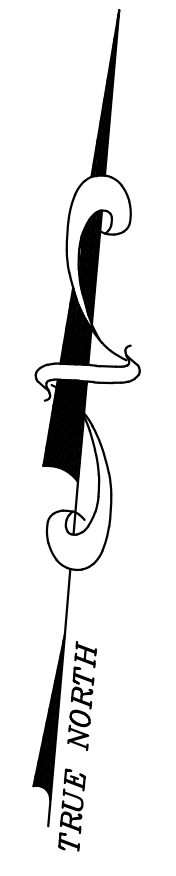

SHEET 12

NEW BRUNSWICK AVENUE
 EMMETT AVENUE

CITY OF PERTH AMBOY
 MIDDLESEX COUNTY